

LINEAR SHAFTS AND BALL BUSHINGS

► LMEH SERIES (EUROPE SERIES)

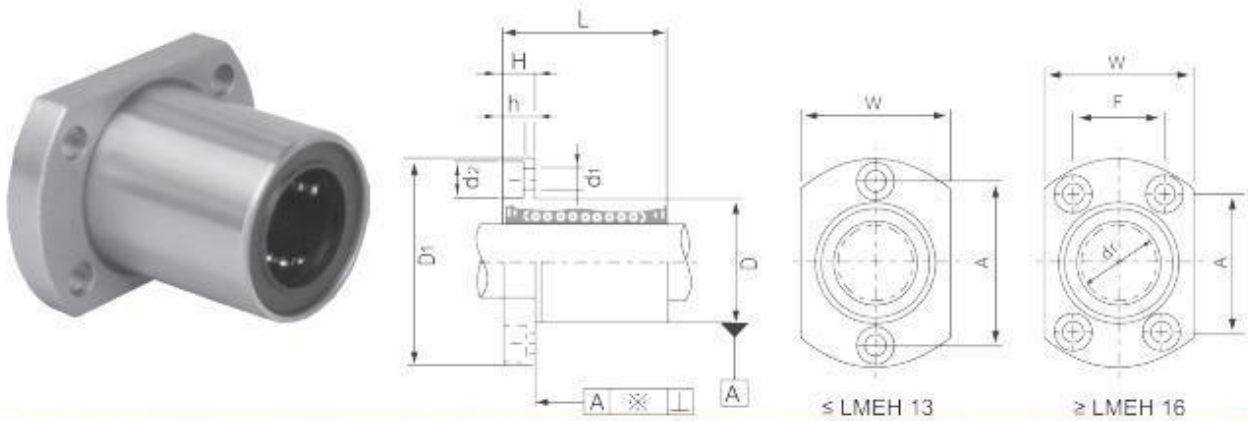

Type	Ball circuit	dr		D		L (±0,3)	D1	W	A	F	H	d1xd2xh	Eccentricity (max.)	Radial clearance (max.)	Load		Weight
		(mm)	(μm)	(mm)	(μm)										C	C0	
LMEH12UU	4	12	+8 / 0	22	0	32	42	32	32	-	6	4,5x7,5x4,1	12	-4	510	784	80
LMEH16UU	5	16	+9	26	-13	36	46	34	31	22	6	4,5x7,5x4,1			578	892	103
LMEH20UU	5	20	+1	32		45	54	39	36	24	8	5,5x9x5,1			862	1370	182
LMEH25UU	6	25	+11	40	0	58	62	42	40	32	8	5,5x9x5,1	15	-6	980	1570	335
LMEH30UU	6	30	-1	47	-16	68	76	54	49	35	10	6,6x11x6,1		-8	1570	2740	560