

LINEAR SHAFTS AND BALL BUSHINGS

► TBR SERIES

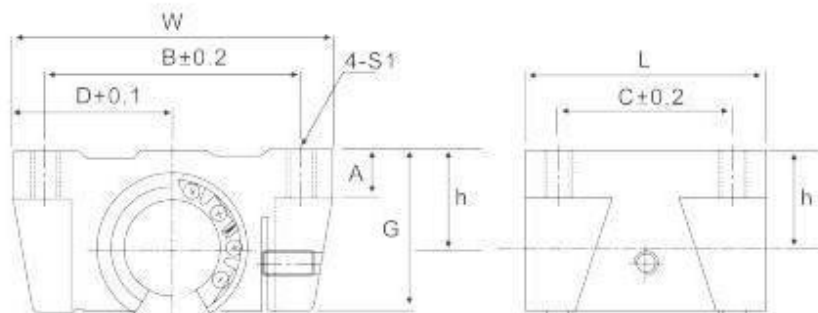

Type	W	G	A	L	B	D	C	h	S1	Load		Weight
										C	C0	
										(N)	(N)	
TBR16UU	62	26	8	42	50	31	30	18	M5	392	490	180
TBR20UU	68	31	10	51	54	34	37	21	M6	784	1176	300
TBR25UU	82	41	12	65	65	41	50	28	M8	1568	2352	600
TBR30UU	91	48	12	75	75	45,5	60	33,5	M8	1764	2940	900